

Plotted: 12/17/21 - 5:11 PM, By: jdemartins
File: P:\CEPC PROJECTS\1423 Capital Seniors Housing\99-006 Old Tappan\dwg\Site Plans\142399006SES.dwg, --> 10 SOIL EROSION & SEDIMENT CONTROL PLAN

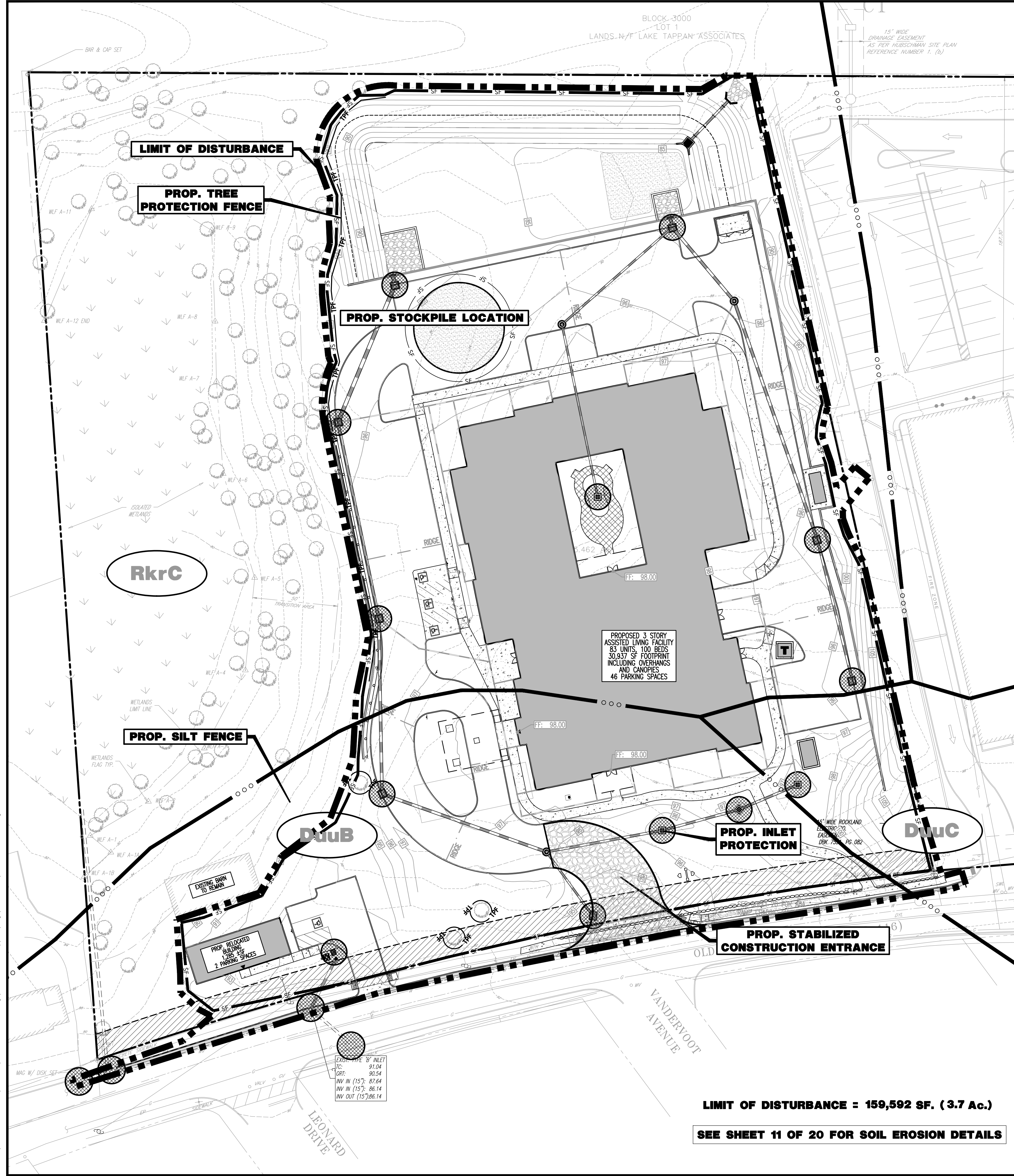

LIMIT OF DISTURBANCE = 159,592 SF. (3.7 Ac.)

SEE SHEET 11 OF 20 FOR SOIL EROSION DETAILS

THIS PLAN TO BE UTILIZED FOR SOIL EROSION & SEDIMENT CONTROL PURPOSES ONLY

BERGEN COUNTY SOIL CONSERVATION DISTRICT SOIL EROSION & SEDIMENT CONTROL NOTES:

- ALL SOIL EROSION AND SEDIMENT CONTROL PRACTICES WILL BE INSTALLED IN ACCORDANCE WITH THE STANDARDS FOR SOIL EROSION AND SEDIMENT CONTROL IN NEW JERSEY (NJ STANDARDS), AND WILL BE INSTALLED IN PROPER SEQUENCE AND MAINTAINED UNTIL PERMANENT STABILIZATION IS ESTABLISHED.
- ANY DISTURBED AREA THAT WILL BE LEFT EXPOSED FOR MORE THAN THIRTY (30) DAYS AND NOT SUBJECT TO CONSTRUCTION TRAFFIC SHALL IMMEDIATELY RECEIVE A TEMPORARY SEEDING AND MULCHING. IF THE SEASON PROHIBITS TEMPORARY SEEDING, THE DISTURBED AREA WILL BE MULCHED WITH UNROTTED STRAW AT A RATE OF 2 TONS PER ACRE ANCHORED BY APPROVED METHODS (I.E. PEG AND TWINE, MULCH NETTING, OR LIQUID MULCH BINDER).
- IMMEDIATELY FOLLOWING INITIAL DISTURBANCE OR ROUGH GRADING, ALL CRITICAL AREAS SUBJECT TO EROSION WILL RECEIVE A TEMPORARY SEEDING IN COMBINATION WITH STRAW MULCH OR A SUITABLE EQUIVALENT, AT A RATE OF 2 TONS PER ACRE, ACCORDING TO THE NJ STANDARDS.
- STABILIZATION SPECIFICATIONS:
 - TEMPORARY SEEDING AND MULCHING:

GROUND LIMESTONE - APPLIED UNIFORMLY ACCORDING TO SOIL TEST RECOMMENDATIONS.

FERTILIZER - APPLY 11LBS. /1,000 SF OF 10-20-10 OR EQUIVALENT WITH 50% WATER INSOLUBLE NITROGEN (UNLESS A SOIL TEST INDICATES OTHERWISE) WORKED INTO THE SOIL A MINIMUM OF 4".

SEED - PERENNIAL RYEGRASS 100 LBS. /ACRE (2.3 LBS. /1,000 SF) OR OTHER APPROVED SEED; PLANT BETWEEN MARCH 1 AND MAY 15 OR BETWEEN AUGUST 15 AND OCTOBER 1.

MULCH - UNROTTED STRAW OR HAY AT A RATE OF 70 TO 90 LBS. /1,000 SF APPLIED TO ACHIEVE 95% SOIL SURFACE COVERAGE. MULCH SHALL BE ANCHORED BY APPROVED METHODS (I.E. PEG AND TWINE, MULCH NETTING, OR LIQUID MULCH BINDER).
 - PERMANENT SEEDING AND MULCHING:

TOPSOIL - A UNIFORM APPLICATION TO AN AVERAGE DEPTH OF 5", MINIMUM OF 4" FIRMED IN PLACE IS REQUIRED.

GROUND LIMESTONE - APPLIED UNIFORMLY ACCORDING TO SOIL TEST RECOMMENDATIONS.

FERTILIZER - APPLY 11 LBS. /1,000 SF OF 10-10-10 OR EQUIVALENT WITH 50% WATER INSOLUBLE NITROGEN (UNLESS A SOIL TEST INDICATES OTHERWISE) WORKED INTO THE SOIL A MINIMUM OF 4".

SEED - TURF TYPE TALL FESCUE (BLEND OF 3 CULTIVARS) 350 LBS. /ACRE (8 LBS. /1,000 SF) OR OTHER APPROVED SEED; PLANT BETWEEN MARCH 1 AND OCTOBER 1 (SUMMER SEEDING REQUIRES IRRIGATION).

MULCH - UNROTTED STRAW OR HAY AT A RATE OF 70 TO 90 LBS. /1,000 SF APPLIED TO ACHIEVE 95% SOIL SURFACE COVERAGE. MULCH SHALL BE ANCHORED BY APPROVED METHODS (I.E. PEG AND TWINE, MULCH NETTING, OR LIQUID MULCH BINDER).
- THE SITE SHALL AT ALL TIMES BE GRADED AND MAINTAINED SUCH THAT ALL STORMWATER RUNOFF IS DIVERTED TO SOIL EROSION AND SEDIMENT CONTROL FACILITIES.
- SOIL EROSION AND SEDIMENT CONTROL MEASURES WILL BE INSPECTED AND MAINTAINED ON A REGULAR BASIS, INCLUDING AFTER EVERY STORM EVENT.
- STOCKPILES ARE NOT TO BE LOCATED WITHIN 50' OF A FLOODPLAIN, SLOPE, ROADWAY OR DRAINAGE FACILITY. THE BASE OF ALL STOCKPILES SHALL BE CONTAINED BY A HYBALE SEDIMENT BARRIER OR SILT FENCE.
- A CRUSHED STONE VEHICLE WHEEL-CLEANING BLANKET WILL BE INSTALLED WHEREVER A CONSTRUCTION ACCESS ROAD INTERSECTS ANY PAVED ROADWAY. SAID BLANKET WILL BE COMPOSED OF 1" - 2 1/2" CRUSHED STONE, 6" THICK, WILL BE AT LEAST 30' X 100' AND SHOULD BE UNDERLAIN WITH A SUITABLE SYNTHETIC SEDIMENT FILTER FABRIC AND MAINTAINED.
- MAXIMUM SIDE SLOPES OF ALL EXPOSED SURFACES SHALL NOT EXCEED 3:1 UNLESS OTHERWISE APPROVED BY THE DISTRICT.
- DRIVEWAYS MUST BE STABILIZED WITH 1" - 2 1/2" CRUSHED STONE OR SUBBASE PRIOR TO INDIVIDUAL LOT CONSTRUCTION.
- ALL SOIL WASHED, DROPPED, SPILLED OR TRACKED OUTSIDE THE LIMIT OF DISTURBANCE OR ONTO PUBLIC RIGHT-OF-WAYS, WILL BE REMOVED IMMEDIATELY. PAVED ROADWAYS MUST BE KEPT CLEAN AT ALL TIMES.
- CATCH BASIN INLETS WILL BE PROTECTED WITH AN INLET FILTER DESIGNED IN ACCORDANCE WITH SECTION 28-1 OF THE NJ STANDARDS.
- STORM DRAINAGE OUTLETS WILL BE STABILIZED, AS REQUIRED, BEFORE THE DISCHARGE POINTS BECOME OPERATIONAL.
- DEWATERING OPERATIONS MUST DISCHARGE DIRECTLY INTO A SEDIMENT CONTROL BAG OR OTHER APPROVED FILTER IN ACCORDANCE WITH SECTION 14-1 OF THE NJ STANDARDS.
- DUST SHALL BE CONTROLLED VIA THE APPLICATION OF WATER, CALCIUM CHLORIDE OR OTHER APPROVED METHOD IN ACCORDANCE WITH SECTION 16-1 OF THE NJ STANDARDS.
- TREES TO REMAIN AFTER CONSTRUCTION ARE TO BE PROTECTED WITH A SUITABLE FENCE INSTALLED AT THE DRIP LINE OR BEYOND IN ACCORDANCE WITH SECTION 9-1 OF THE NJ STANDARDS.
- THE PROJECT OWNER SHALL BE RESPONSIBLE FOR ANY EROSION OR SEDIMENTATION THAT MAY OCCUR BELOW STORMWATER OUTFALLS OR OFF-SITE AS A RESULT OF CONSTRUCTION OF THE PROJECT.
- ANY REVISION TO THE CERTIFIED SOIL EROSION AND SEDIMENT CONTROL PLAN MUST BE SUBMITTED TO THE DISTRICT FOR REVIEW AND APPROVAL PRIOR TO IMPLEMENTATION IN THE FIELD.
- A COPY OF THE CERTIFIED SOIL EROSION AND SEDIMENT CONTROL PLAN MUST BE AVAILABLE AT THE PROJECT SITE THROUGHOUT CONSTRUCTION.
- THE BERGEN COUNTY SOIL CONSERVATION DISTRICT MUST BE NOTIFIED, IN WRITING, AT LEAST 48 HOURS PRIOR TO ANY LAND DISTURBANCE: BERGEN COUNTY SCD, 700 KINDERKAMACK ROAD, SUITE 106, ORADELL, NJ 07649. TEL: 201-261-4407; FAX 201-261-7573.
- THE BERGEN COUNTY SOIL CONSERVATION DISTRICT MAY REQUEST ADDITIONAL MEASURES TO MINIMIZE ON OR OFF-SITE EROSION PROBLEMS DURING CONSTRUCTION.
- THE OWNER MUST OBTAIN A DISTRICT ISSUED REPORT OF COMPLIANCE PRIOR TO THE ISSUANCE OF ANY CERTIFICATE OF OCCUPANCY. THE DISTRICT REQUIRES AT LEAST ONE WEEK'S NOTICE TO FACILITATE THE SCHEDULING OF ALL REPORT OF COMPLIANCE INSPECTIONS. ALL SITE WORK MUST BE COMPLETED, INCLUDING TEMPORARY/PERMANENT STABILIZATION OF ALL EXPOSED AREAS, PRIOR TO THE ISSUANCE OF A REPORT OF COMPLIANCE BY THE DISTRICT.

REVISED 12/7/17

EROSION CONTROL LEGEND

- PROP. LIMIT OF DISTURBANCE LINE
- PROP. SILT FENCE LINE
- PROP. TREE PROTECTION FENCE LINE
- PROP. INLET FILTER
- PROP. HYBALE SEDIMENT BARRIER

Hydrologic Soil Groups			
Symbol	Name	Rating	Area (Acres)
DuuB	Dunellen-Urban land complex, 3 to 8 percent slopes	A	1.22
DuuC	Dunellen-Urban land complex, 8 to 15 percent slopes	A	0.19
RkrC	Riverhead sandy loam, 8 to 15 percent slopes	B	4.05

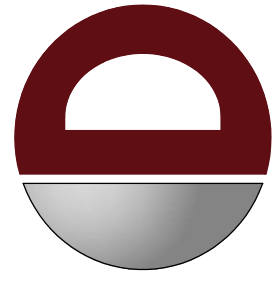

DYNAMIC
ENGINEERING
SURVEY • TRAFFIC

MS	GL	BY
3	12/20/21	REVISED PER UPDATED LAYOUT
2	09/10/21	REVISED PER SCD & COUNTY COMMENTS
1	07/29/21	REVISED PER SCD & COUNTY COMMENTS
REV.	DATE	COMMENTS

THIS PLAN SET IS FOR PERMITTING PURPOSES ONLY AND MAY NOT BE USED FOR CONSTRUCTION

DESIGNED BY: J.D. CHECKED BY: J.D. DTS
DRAWN BY: J.D. CHECKED BY: J.D.

PROJECT: CSH OLD TAPPAN, LLC
PROPOSED ASSISTED LIVING FACILITY
BLOCK 1606, LOT 3
244 OLD TAPPAN ROAD
BOROUGH OF OLD TAPPAN, BERGEN COUNTY, NEW JERSEY



PROTECT YOURSELF
ALL STATES REQUIRE NOTIFICATION OF EXCAVATORS, DESIGNERS, OR ANY PERSON PREPARING TO DIGGING THE EARTH'S SURFACE ANYWHERE IN ANY STATE
FOR STATE SPECIFIC DIRECT PHONE NUMBERS VISIT: WWW.CALL811.COM

DYNAMIC ENGINEERING
LAND DEVELOPMENT CONSULTING • PERMITTING
GEOTECHNICAL • ENVIRONMENTAL
TRAFFIC • SURVEY • PLANNING & ZONING
245 Main Street, Suite 110
Chester, NJ 07930
T: 908.879.9229 | F: 908.879.0222
Offices conveniently located at:

Littleton, Colorado • 1.703.414.1414
Chicago, Illinois • 1.908.879.9229
Newark, New Jersey • 1.973.757.7577
Trenton, New Jersey • 1.732.919.0100
Newtown, Pennsylvania • 1.215.485.0579
Pittsburgh, Pennsylvania • 1.724.333.4000
Albany, Texas • 1.972.534.3100
Houston, Texas • 1.281.780.4400
Austin, Texas • 1.512.644.0400
Del Rio, Texas • 1.512.971.8070

www.dynamiccec.com

DANIEL T. SEHNAL
PROFESSIONAL ENGINEER
NEW JERSEY LICENSE No. 53572

JOSEPH G. JAWORSKI
PROFESSIONAL ENGINEER
NEW JERSEY LICENSE No. 36618

TITLE: **SOIL EROSION & SEDIMENT CONTROL PLAN**

SCALE: (H) 1" = 30'
(V) 1" = 30'
PROJECT No: 1423-99-006
DATE: 05/18/2021

SHEET No: 10
Rev. #: 3
OF 20