

**ADA CROSSWALK AT DRIVEWAY OF ASSISTED LIVING FACILITY**

SCALE: 1" = 5'

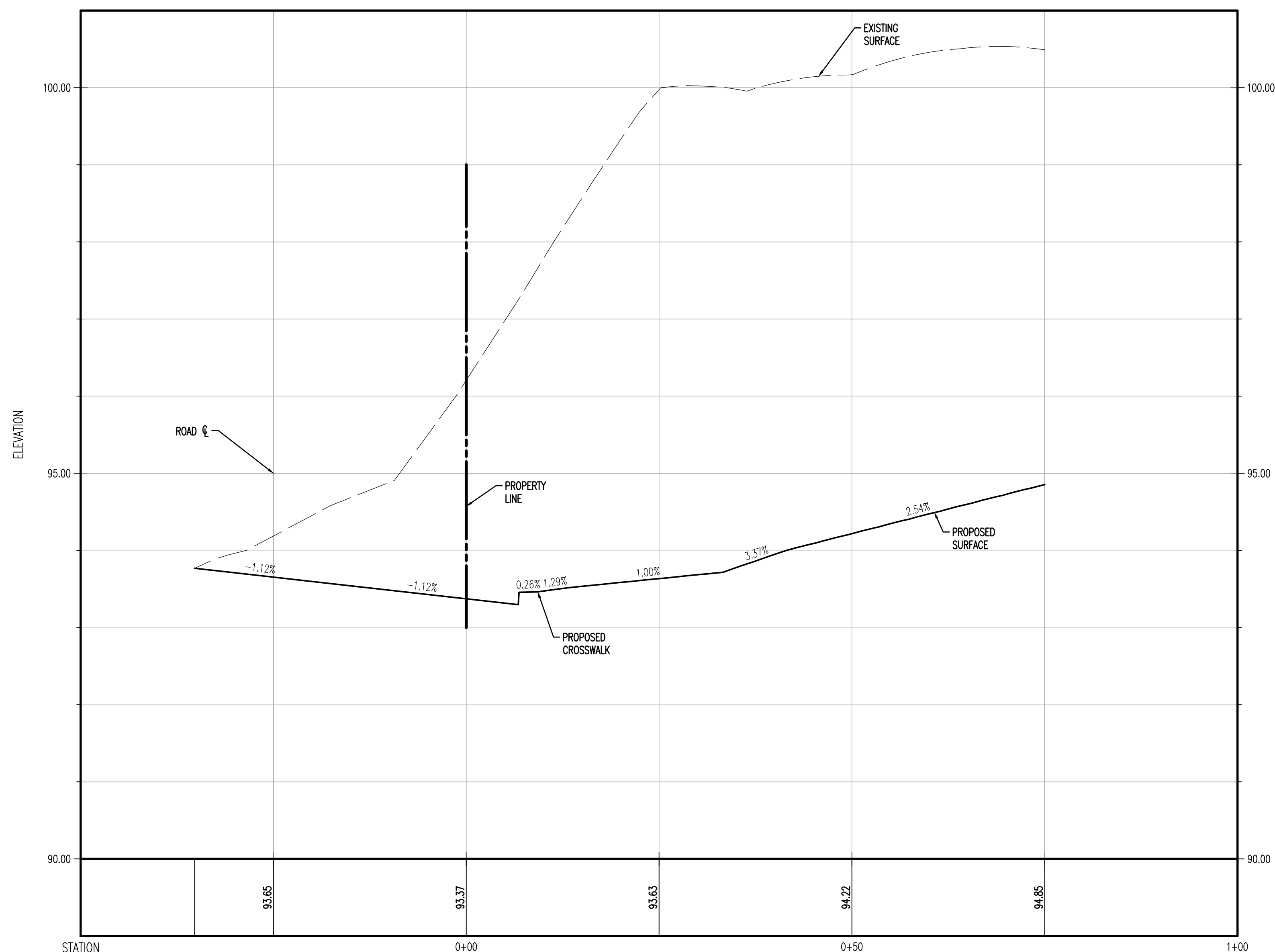

**PROFILE VIEW OF ENTRANCE**  
HORIZONTAL SCALE: 1"=10'  
VERTICAL SCALE: 1"=1'

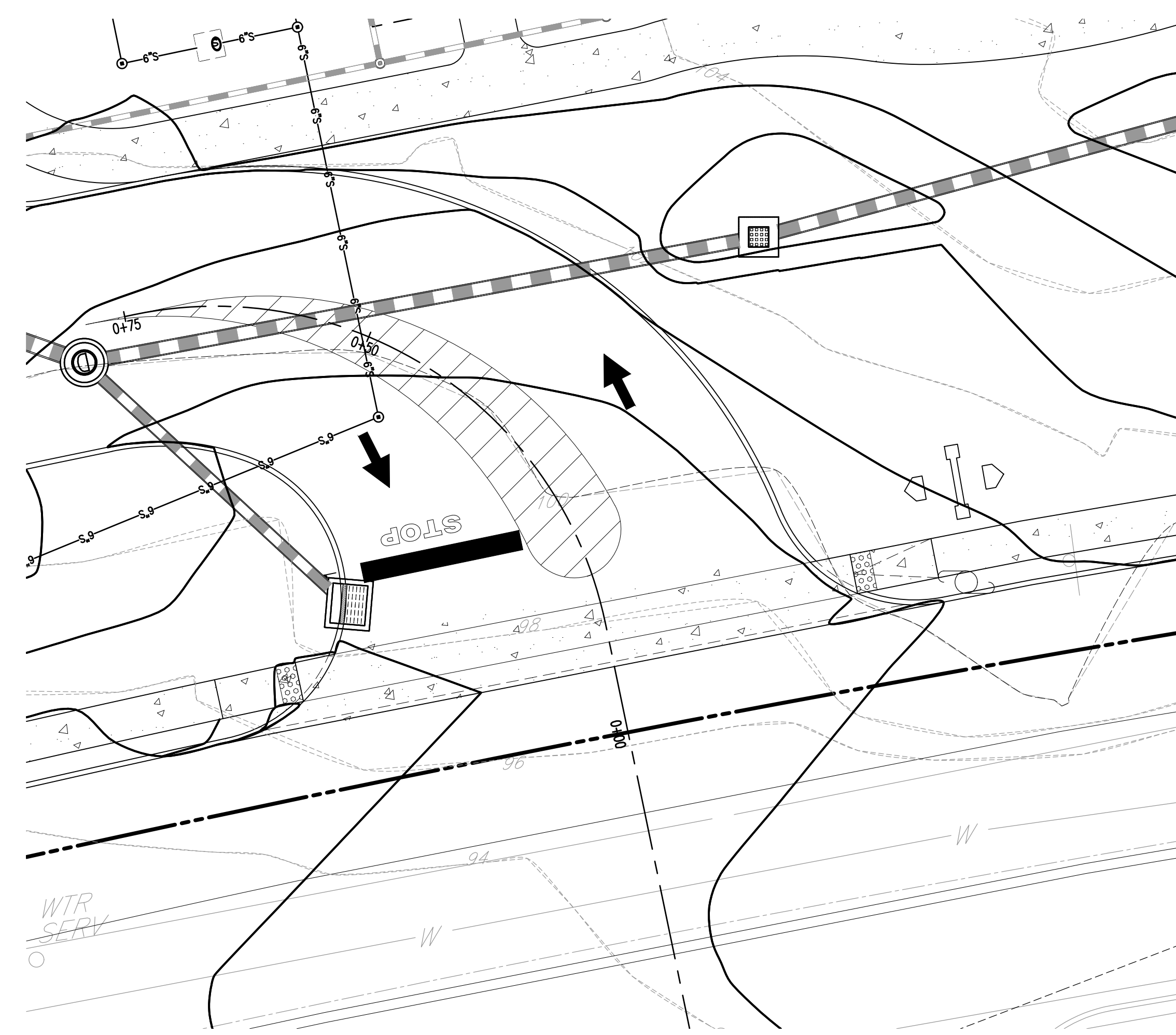

**OLD TAPPAN ROAD DRIVEWAY PLAN**

SCALE: 1" = 10'

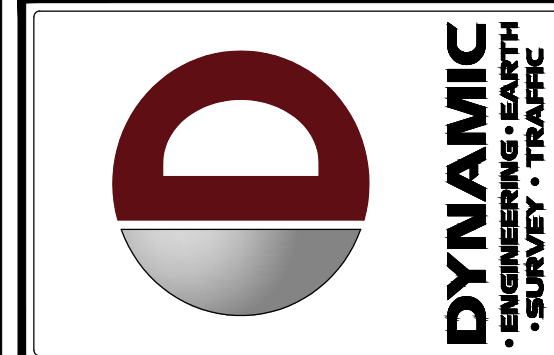
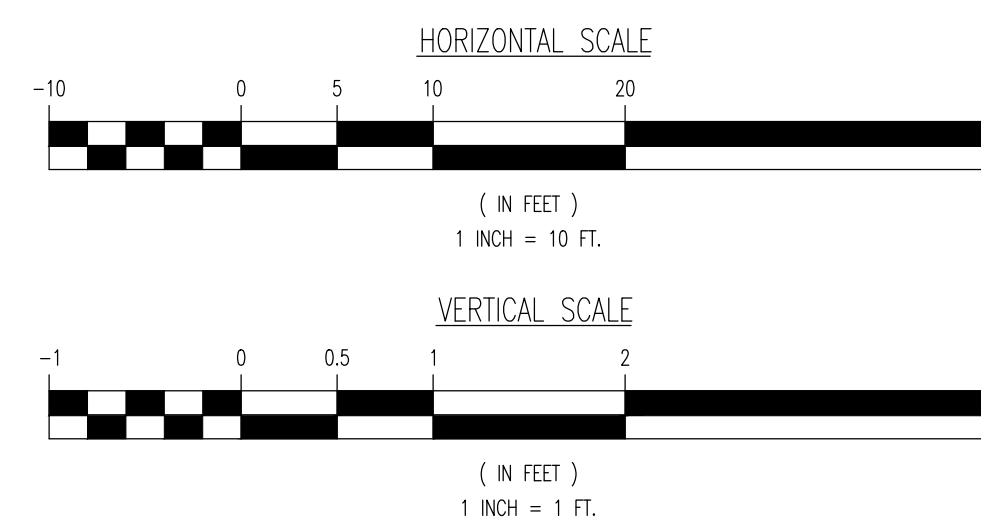

**DYNAMIC**  
ENGINEERING  
SURVEY • TRAFFIC

REV.	DATE	COMMENTS
1	07/29/21	REVISED PER SCD & COUNTY COMMENTS
2	09/10/21	REVISED PER SCD & COUNTY COMMENTS
3	12/20/21	REVISED PER UPDATED LAYOUT
4	02/01/22	REVISED PER SCD COMMENTS
5	03/16/22	NEW REV PER BOROUGH COMMENTS
6	05/02/22	REVISED PER BOROUGH & SCD COMMENTS

THIS PLAN SET IS FOR PERMITTING PURPOSES ONLY AND MAY NOT BE USED FOR CONSTRUCTION

DESIGNED BY: KHC  
CHECKED BY: KHC/DRL  
DTS

PROJECT: **CSH OLD TAPPAN, LLC**  
**PROPOSED ASSISTED LIVING FACILITY**  
BLOCK 1606, LOT 3  
244 OLD TAPPAN ROAD  
BOROUGH OF OLD TAPPAN, BERGEN COUNTY, NEW JERSEY

**811** PROTECT YOURSELF  
ALL STATES REQUIRE NOTIFICATION OF EXCAVATORS, DESIGNERS, OR ANY PERSON PREPARING TO DIG INTO THE EARTH'S SURFACE ANYWHERE IN ANY STATE  
FOR STATE SPECIFIC DIRECT PHONE NUMBERS VISIT: [WWW.CALL811.COM](http://WWW.CALL811.COM)

**DYNAMIC ENGINEERING**  
LAND DEVELOPMENT CONSULTING • PERMITTING  
GEOTECHNICAL • ENVIRONMENTAL  
TRAFFIC • SURVEY • PLANNING & ZONING  
245 Main Street, Suite 110  
Chester, NJ 07930  
T: 908.879.9229 | F: 908.879.0222  
Offices conveniently located at:  
Littleton, New Jersey • 1.762.714.1100  
Cherry Hill, New Jersey • 1.908.879.0229  
Newark, New Jersey • 1.973.759.7200  
Somers Hill, New Jersey • 1.201.942.8100  
Newtown, Pennsylvania • 1.212.485.0278  
Pittsburgh, Pennsylvania • 1.724.233.4888  
Arlon, Texas • 1.972.534.3100  
Houston, Texas • 1.281.789.4400  
Arlon, Texas • 1.281.644.0400  
Daly City, California • 1.510.911.8070

[www.dynamiccec.com](http://www.dynamiccec.com)

**DANIEL T. SEHNAL**  
PROFESSIONAL ENGINEER  
NEW JERSEY LICENSE No. 53572

**JOSEPH G. JAWORSKI**  
PROFESSIONAL ENGINEER  
NEW JERSEY LICENSE No. 36618

TITLE: **ADA RAMP & DRIVEWAY PROFILE EXHIBIT**

SCALE: (H) AS SHOWN DATE: 05/18/2021  
PROJECT No: 1423-99-006

SHEET No: **20** OF 20  
Rev. #: 6