

ADA CROSSWALK AT OLD TAPPAN ROAD DRIVEWAY

SCALE: 1" = 5'

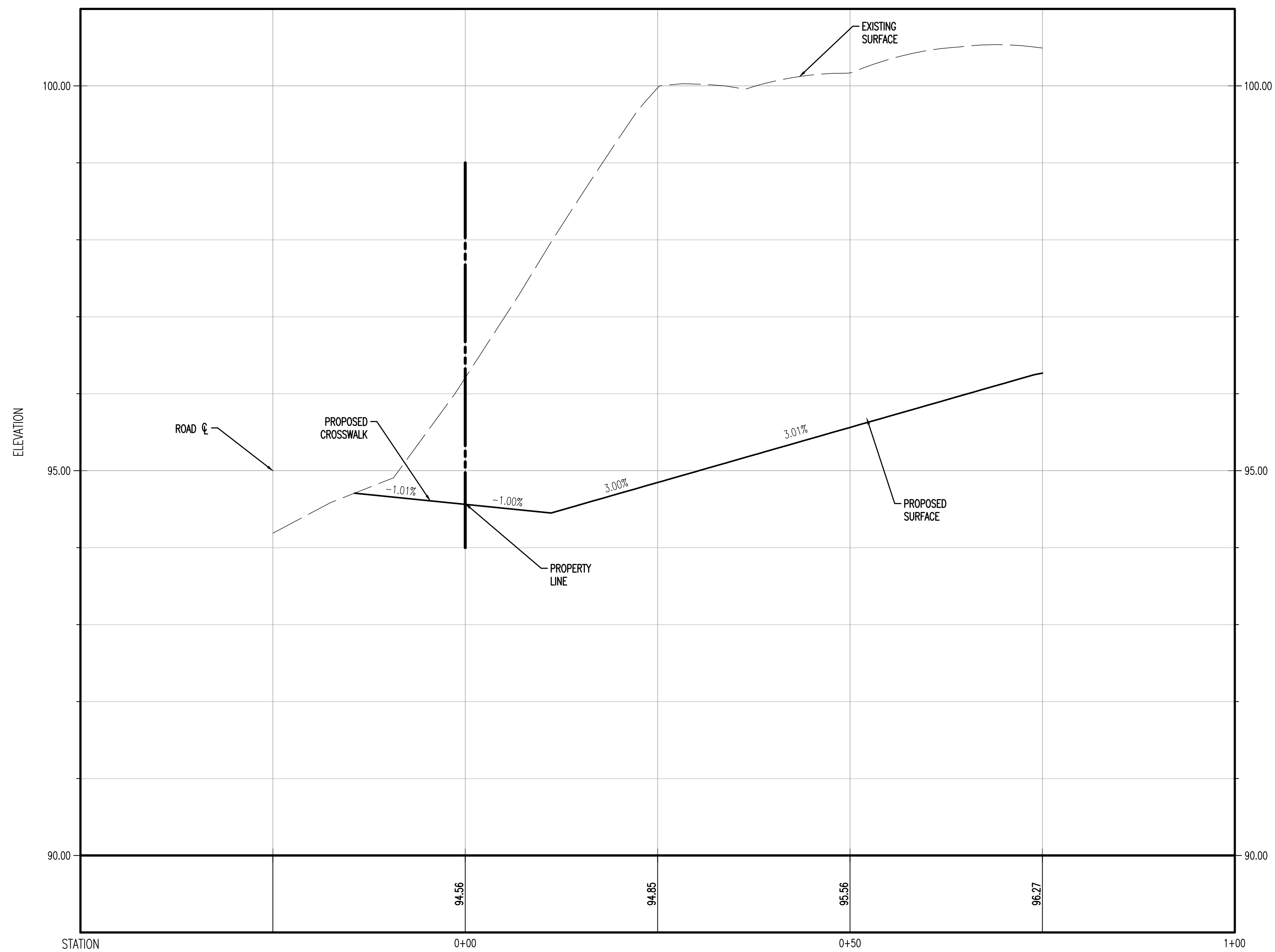

PROFILE VIEW OF ENTRANCE
HORIZONTAL SCALE: 1"=10'
VERTICAL SCALE: 1"=1'

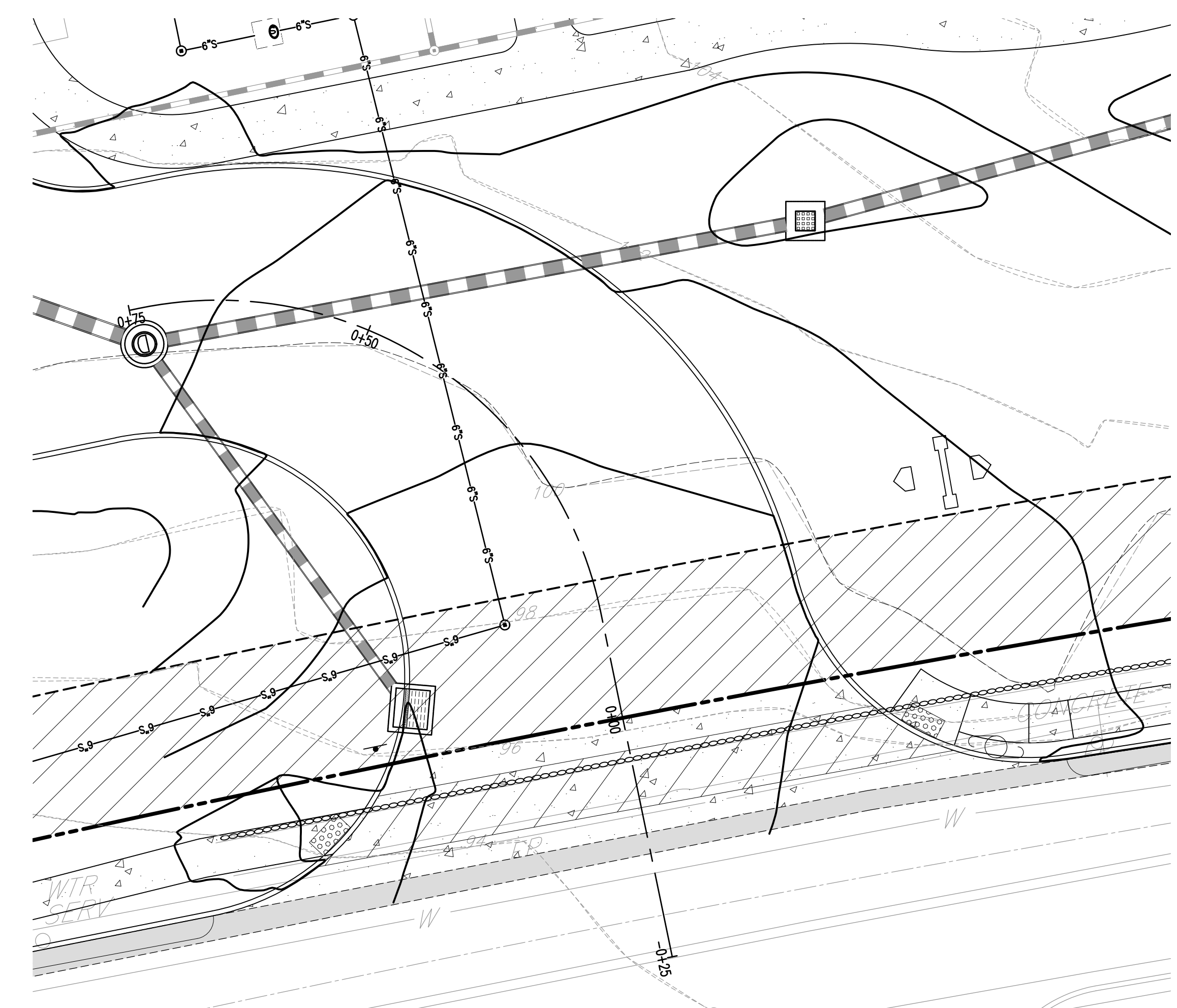

OLD TAPPAN ROAD DRIVEWAY PLAN

SCALE: 1" = 10'

Plotted: 12/17/21 - 5:14 PM, By: jdemartini
File: P:\VEPC PROJECTS\1423 Capital Seniors Housing\99-006 Old Tappan\DWG\Site Plans\142399006\03.dwg, ----> 20 ADA RAMP & DRIVEWAY PROFILE EXHIBIT

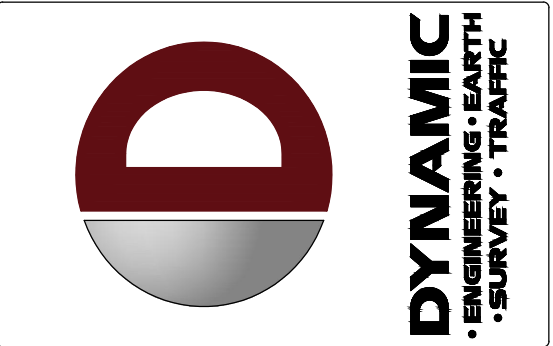

REV.	DATE	COMMENTS	BY
1	07/29/21	REVISED PER SCD & COUNTY COMMENTS	DL
2	09/10/21	REVISED PER SCD & COUNTY COMMENTS	DL
3	12/20/21	REVISED PER UPDATED LAYOUT	MS

THIS PLAN SET IS FOR PERMITTING PURPOSES ONLY AND MAY NOT BE USED FOR CONSTRUCTION

DRAWN BY: KHC
 CHECKED BY: KHC/DRL
 DESIGNED BY: DTS
 PROJECT: **CSH OLD TAPPAN, LLC**
 PROPOSED ASSISTED LIVING FACILITY
 BLOCK 1606, LOT 3
 244 OLD TAPPAN ROAD
 BOROUGH OF OLD TAPPAN, BERGEN COUNTY, NEW JERSEY

811 PROTECT YOURSELF
 ALL STATES REQUIRE NOTIFICATION OF EXISTING UTILITIES BEFORE ANY PERSON PREFERS TO DIG THE EARTH'S SURFACE ANYWHERE IN ANY STATE
 FOR STATE SPECIFIC DIRECT PHONE NUMBERS VISIT: WWW.CALL811.COM

DYNAMIC ENGINEERING
 LAND DEVELOPMENT CONSULTING • PERMITTING
 GEOTECHNICAL • ENVIRONMENTAL
 TRAFFIC • SURVEY • PLANNING & ZONING
 245 Main Street, Suite 110
 Chester, NJ 07930
 T: 908.879.9229 | F: 908.879.0222
 Offices conveniently located at:
 Littleton, New Jersey • 1.762.714.1111
 Chester, New Jersey • 1.908.879.9229
 Newark, New Jersey • 1.973.759.7200
 Fort Mill, New Jersey • 1.757.942.8100
 New York, Pennsylvania • 1.212.485.8278
 Philadelphia, Pennsylvania • 1.215.253.4888
 Allentown, PA • 1.717.253.1000
 Houston, Texas • 1.281.789.4800
 Dallas, Texas • 1.214.644.9494
 Del Rio, Texas • 1.561.911.8070

DANIEL T. SEHNAL
 PROFESSIONAL ENGINEER
 NEW JERSEY LICENSE No. 53572

JOSEPH G. JAWORSKI
 PROFESSIONAL ENGINEER
 NEW JERSEY LICENSE No. 36618

TITLE: **ADA RAMP & DRIVEWAY PROFILE EXHIBIT**

SCALE: (H) AS SHOWN DATE: 05/18/2021
 PROJECT No: 1423-99-006

SHEET No: **20** OF 20 Rev. #: 3